

USER GUIDE



Introduction The **PL-2** is a remote control device available for use with the Allen & Heath DR-switch or iDR-switch logic expanders. It is a wall plate or furniture mounted module comprising plastic control panel and attached circuit assembly. It can be mounted in a single unit wall box using a standard face plate (UK, EU or US version supplied). A pre-cut brushed aluminium EU (AA5029) or US (AA5030) plate is supplied. The **PL-2** interfaces with the DR/iDR-switch rear panel SWITCH INPUTS and LOGIC outputs ports. The number of **PL-2** units which may be connected is determined by the number of remote switch and logic output lines from the DR/iDR system and how many you wire to each PL unit. The wall plate switch and indicator functions are programmed using the Allen & Heath WinDR (DR-switch) or iDR System Manager (iDR-switch) software. Space is provided on the control panel for custom labelling. The following combination of controls makes the **PL-2** ideal as a wall mounted room remote controller in installed audio systems. The installer can program the unit so that the non-technical operator has local control using pre-programmed switches LEDs.

4 switches For DR-switch they can be assigned for level up or down control (input, output, or crosspoint), mute toggle or patch recall. For iDR-switch they can be assigned for level up or down control (input, output, crosspoint or group), mute toggle, polarity toggle, audio monitor select, or patch recall. **4 LED indicators** For DR-switch they can be assigned to display input or output channel mute status, or as patch related static indicators. For iDR-switch they can be assigned as audio meters (choice of 8 points in the signal path), mute status, polarity status, or as patch related static display. Each can be wired to display either red or green. Two DR/iDR-switch outputs can be used to switch one LED to red, green or yellow. **Custom labels** Recessed areas are provided for fitting custom adhesive labels. Recommended maximum sizes are 6x26mm and 26x9mm (h x w).



IMPORTANT :

Note : The **PL-2** differs from the **PL-1** only in that it includes an adapter card that fits into the DR/iDR-switch logic output connector plug. This routes the +10V reference voltage via resistors to the open collector '+' pins. You wire the '-' pins to the **PL-2** connectors. The **PL-1** does not include the adapter card.

CE This product complies with the European Electromagnetic Compatibility directives 89/336/EEC & 92/31/EEC.

NOTE: Any changes or modifications to the equipment not approved by Allen & Heath could void the compliance of the equipment. Whilst we believe the information in this guide to be reliable we do not assume responsibility for inaccuracies. We also reserve the right to make changes in the interest of further product development.

PL-2 User Guide AP5080 Issue 1

Copyright© 2003 Allen & Heath Ltd. All rights reserved.

! Observe the local standards which may apply to the installation regarding the grade of cable and installation methods.

! To ensure operator safety ensure that any exposed metal face plates are correctly bonded to ground. Do not install the equipment where it is subject to moisture, heat or vibration.

! Connect this equipment to the Allen & Heath DR-switch or iDR-switch only. It is very important to test for correct wiring and installation before switching the equipment on.

! The DR/iDR-switch provides opto-isolated contact closure switch inputs and open collector logic outputs. How these are wired to external equipment is the responsibility of the installer. Details are provided here for wiring to the PL-2 wall plate. Allen & Heath do not assume responsibility for any damage done to the equipment due to incorrect or faulty installation.

Aligning the arrow keys The four switch caps can be rotated so that the arrow faces up, down, left or right. Decide which way you want them to face according to function, for example volume or source select.



To change them, first remove the four screws (B) and lift away the PCB. Rotate the switch caps into the required position. Reassemble the module.

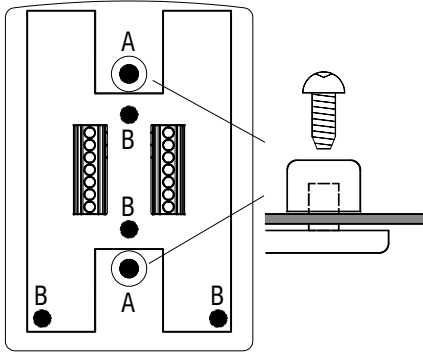

Mounting into the face plate A pre-cut brushed aluminium UK (part number AA5029), EU (AA5250) or US (AA5030) plate is supplied. A backing box for the UK plate can be supplied (AA5220).

The assembled module fits into an 'H' shaped cutout in the centre of the mounting plate. The module is held using the two screws with plastic clamps provided (A). Unscrew these from the module first. Dimensions are in millimetres below.

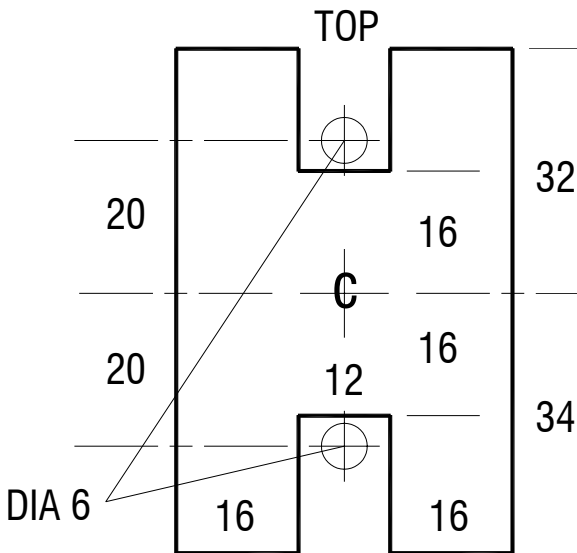

Grounding a metal plate If the face plate is metal make sure that it is correctly grounded to ensure operator safety. The plate should be connected to a local safety ground, not the DR/iDR-switch G pin or cable shield. Use a ground wire or physical contact with a grounded back box.



Wiring standards Use flame retardent shielded cable that meets the requirements of the installation. We recommend the multi-stranded rather than solid conductor type. Screw terminal blocks are provided for the switch and LED connections. Use a small flat bladed screwdriver. Ensure the wires are correctly stripped and formed to allow sufficient service loop in the backing box.

Wiring to the DR/iDR-switch Connect each DR/iDR-switch SWITCH INPUT pin to the required PL-2 SW terminal. Wire the DR/iDR-switch G (ground) pin to the PL-2 0V common terminal.

Connect the LOGIC OUTPUT – (emitter) pins to the required R or G LED terminal as shown below, and 0V common to the G pin. Link the +10V internal supply to the output + (collector) pins using the adapter card AG5222. Connect the cable shield to the ground terminal next to the LOGIC OUTPUT connectors.

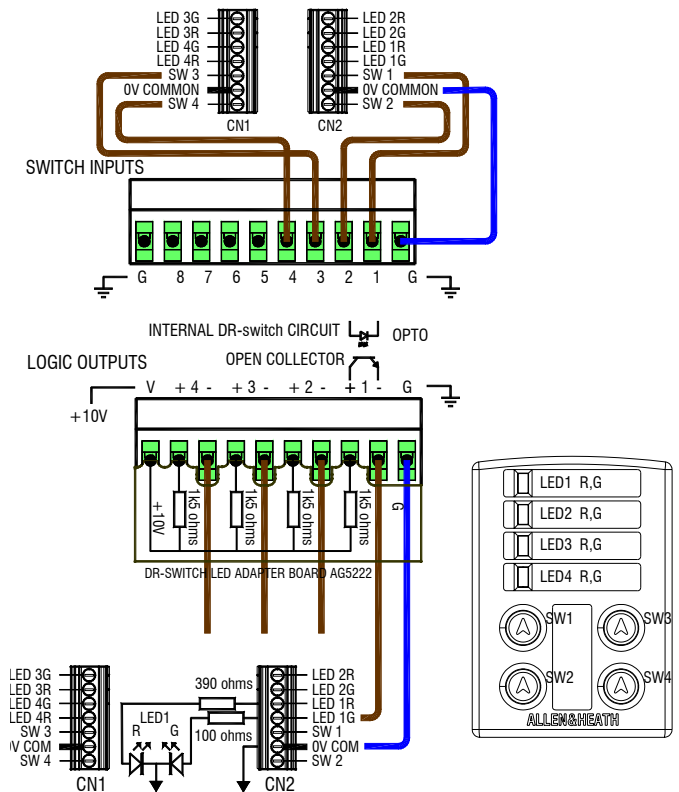

Deciding the LED colour Wire to the G terminal for green, or to the R terminal for red, or both for yellow. Wire two logic outputs to G and R of the same LED to switch between the three colours.

Assigning the controls The function of the LEDs and switches is assigned using the Allen & Heath WinDR (DR-switch) or iDR System Manager (iDR-switch) software. First ensure the wall plates are correctly wired to the DR/iDR-switch. Connect your PC to the DR or iDR and run the application. For full details refer to the application Help file.

Specification

- Switch Press-to-make Current = 4mA
- LED 3-colour Red = 390 ohm series resistor
- Green = 100 ohm series resistor
- Yellow = Both red and green on
- Adapter card = 1k5 ohm series resistors
- LED current using adapter card = 6mA max
- Max ground current = 60mA (4 switch, 8 LED)